



**European
WATERWAYS**

EST. 1974



The Caledonian Canal and Loch Ness
Cruise aboard 'Scottish Highlander'



*Eilean Donan Castle
(VisitScotland/Scottish Viewpoint)*

CRUISE THE GREAT GLEN Aboard the 8 passenger Scottish Highlander

We cruise sedately along the Great Glen from Inverness towards Fort William, navigating lochs, rivers and the scenic and absorbing Caledonian Canal. Ancient castles leading to the waters edge, heather-clad hillsides and arguably the finest inland cruising in the world. The legends of the past, the taste of single malt and the mythical inhabitant of Loch Ness all contribute to a special magic only experienced in Scotland's dramatic Highlands.

Scottish Highlander has the atmosphere of a Scottish country house with subtle use of tartan furnishings and landscape paintings. At 117 feet she is spacious and has every comfort for year-round cruising.

Cuisine is traditional Scottish fare – salmon, game and seafood, prepared by your own Master Chef, and the barge's experienced crew of four will take care of your every need.

A cruise aboard Scottish Highlander along the Great Glen as you admire some of Scotland's finest scenery will be unforgettable.

TYPICAL SCOTTISH CUISINE ABOARD

REGIONAL SPECIALITIES

Munro of Marinated Salmon;
Pheasant Breast with Apple and
Drambuie; Sirloin of Aberdeen
Angus Beef with Mustard Mash

CHEESE BOARD

Scottish Brie; Whisky Chase;
Dunsyre Blue; Connage Smoked

The Traditional and Spectacular Highlands



CALEDONIAN CANAL, SCOTLAND

SCOTTISH HIGHLANDER

DAILY ITINERARY ABOARD*

SEVEN DAYS/SIX NIGHTS

Sunday, Day 1

DOCHGARROCH

Guests are met at a designated hotel in Inverness at 4pm and transferred to hotel barge Scottish Highlander moored at Dochgarroch. A Champagne Welcome followed by a short evening cruise. Dinner aboard.

Monday, Day 2

DOCHGARROCH TO FORT AUGUSTUS

This morning we visit the 14thC fairytale Cawdor Castle immortalised in Shakespeare's Macbeth. Cawdor contains a superb collection of tapestries, pictures and furniture, and has beautiful landscaped gardens. We also visit Culloden Moor, scene of the last famous battle in 1746. After lunch we cruise Loch Dochfour to Fort Augustus, anchoring for tea beneath Urquhart Castle, then cruise the Loch Ness south shore, with its abundance of wildlife, to moor near Fort Augustus Abbey. Dinner aboard.

Tuesday, Day 3

FORT AUGUSTUS

After breakfast we cruise up the 5-lock staircase through the village of Fort Augustus, with time to shop and look around this pretty Caledonian gem. After lunch we visit Urquhart Castle and Invermoriston Falls (or with family charters explore the Nessie Museum). Fort Augustus also has a charming heather-lined golf course with green-keeping sheep! Later in the day, when available, we watch a sheepdog trial demonstration. We dine out tonight at a local restaurant.

Wednesday, Day 4

FORT AUGUSTUS TO CULLOCHY LOCK

This morning we cruise to Cullochly Lock via Kytra then, after lunch, drive through Glen Moriston and stunning highland countryside to romantic Eilean Donan Castle, setting for the film 'Highlander'. Eilean Donan has an idyllic island setting with commanding views of three sea lochs and frequent sightings of otters, dolphins and the distant Isle of Skye. Dinner aboard.

Thursday, Day 5

CULLOCHY LOCK TO GAIRLOCHY

Today we leave Cullochly Lock for a morning cruise via two locks at Laggan, and through Lochs Oich and Lochy to Gairloch, stopping to try some trout fishing from the barge's foredeck. In the afternoon we visit the World War II Commando memorial and the woollen shops at Spean Bridge, selling traditional knitwear and tweeds. On the way back to the barge we enjoy a mountain gondola trip up the slopes of Aonach Mor to enjoy the panoramic scenery from above. Dinner aboard.

Friday, Day 6

GAIRLOCHY TO BANAVIE

In the morning we visit the mystic battlefields of Glencoe, followed by a fascinating tour of the Ben Nevis distillery and taste a wee dram or two. Afternoon cruise to Banavie and Neptune's Staircase, a flight of eight locks and a spectacular feat of engineering. Farewell Captains' Dinner on board.

Saturday, Day 7

BANAVIE

After a hearty Scottish breakfast, passengers disembark for the minibus transfer to Inverness by 11am.

3 NIGHT CRUISES

3 night cruises aboard **Scottish Highlander** from Dochgarroch to Fort Augustus and from Fort Augustus to Banavie are also offered, subject to availability. On each 3 night cruise, the daily itineraries are the same or similar to those shown above.

*This is a sample itinerary and is subject to change. On alternate weeks the cruise is in the reverse direction.



SOME OF THE SINGLE MALT WHISKIES SERVED ABOARD

- Ben Nevis 10 Year Old
- Lagavulin
- Glenfiddich 12 Year Old
- Dalwhinnie
- Glenmorangie
- Glen Moray
- Bowmore 18 Year Old
- Isle of Jura 18 Year Old
- Auchentoshan 12 Year Old

CRUISE HIGHLIGHTS

- Visit Glencoe, scene of treachery between the Campbell and MacDonald clans
- Tour of the Ben Nevis whisky distillery
- Cruise Lochs Ness, Oich, Lochy and Dochfour
- See Eilean Donan and Urquhart castles
- Culloden Moor, scene of the last battle on British soil in 1746
- Cawdor Castle, home of Shakespeare's Macbeth
- Spectacular scenery, wildlife and folklore
- Hear romantic Scottish sagas from a local story-teller after dinner

WHAT IS INCLUDED

A 6 night cruise aboard Scottish Highlander includes accommodation in air-conditioned, en suite cabins, all gourmet meals aboard and ashore, fine wines, a champagne welcome, an all day open bar, all excursions and admittance fees, local transfers and, of course, the services of the experienced crew.

DECK PLAN

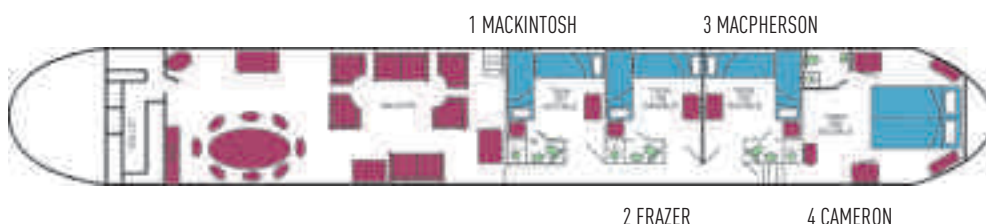

- 117 FEET LONG
- 8 PASSENGERS
- 4 CREW

- 1 TWIN/DOUBLE SUITE
- 3 TWIN/DOUBLE STATEROOMS
- CENTRALLY HEATED

- SMALL SUN DECK
- 8 TOURING BIKES
- FISH FINDER

- ALL WEATHER PASSENGER-FRIENDLY WHEELHOUSE
- MINIBUS



European WATERWAYS

EST. 1974

